



Salisbury Street



£800

56 Merrial Street
Newcastle under Lyme
ST5 2AW
01782 625734



22 Salisbury Street ST6 6BS

A charming two-bedroom mid-terraced home in a vibrant area of Stoke-On-Trent, this property has been thoughtfully refurbished throughout, offering a delightful blend of modern comfort and classic appeal. As you step inside, you will be greeted by two spacious reception rooms, perfect for entertaining guests or enjoying quiet evenings at home. The newly fitted kitchen comes complete with modern appliances. To the first floor there are two generously sized double bedrooms, providing ample space for relaxation and rest. The entire home features new carpets and is fully redecorated, adding a fresh and inviting touch to each room. Outside there is a private enclosed rear yard.

This property is available NOW.

£800



IMPORTANT INFORMATION



22 Salisbury Street, Stoke-on-Trent, ST6 6BS

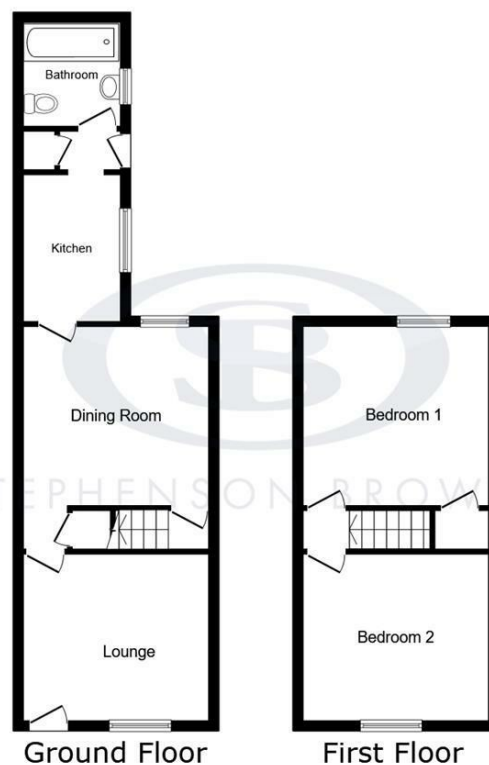

This floor plan is for illustrative purposes only. It is not drawn to scale. Any measurements, floor areas (including any total floor area), openings and orientations are approximate. No details are guaranteed, they cannot be relied upon for any purpose and do not form any part of any agreement. No liability is taken for any error, omission or misstatement. A party must rely upon its own inspection(s). Powered by www.Propertybox.io



Stephenson Browne Estate Agents

Newcastle
56 Merrial Street, Newcastle under Lyme
Staffordshire, ST5 2AJ
Tel: 01782 625734

Sandbach
38 High Street, Sandbach
Cheshire, CW11 1AN
Tel: 01270 763200

Alsager
13 Crewe Road, Alsager
Stoke on Trent, ST7 2EW
Tel: 01270 883130

NOT TO SCALE These floor plans are given as a guide only. Full completed measurements and details should be verified by any intending purchasers legal representative.

NOTICE: Stephenson Browne for themselves and for the vendors or lessors of this property whose agents they are give notice that: (1) the particulars are set out as a general guideline only for the guidance of intending purchasers or lessees, and do not constitute, nor constitute part of, an offer or contract; (2) all descriptions, dimensions, references to condition and necessary permissions for use and occupation, and other details are given in good faith and are believed to be correct but any intending purchasers or tenants should not rely on them as statements or representations of fact but must satisfy themselves by inspection or otherwise as to the correctness of each theme; (3) no person in the employment of Stephenson Browne has any authority to make representation or warranty whatever in relation to this property. (4) fixtures & fittings are subject to a formal list supplied by the vendors solicitors.